

SECUNORM HANDY MDP

USAGE

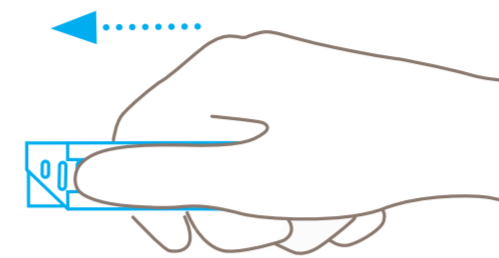

Use the slider to **engage the blade** for cutting.

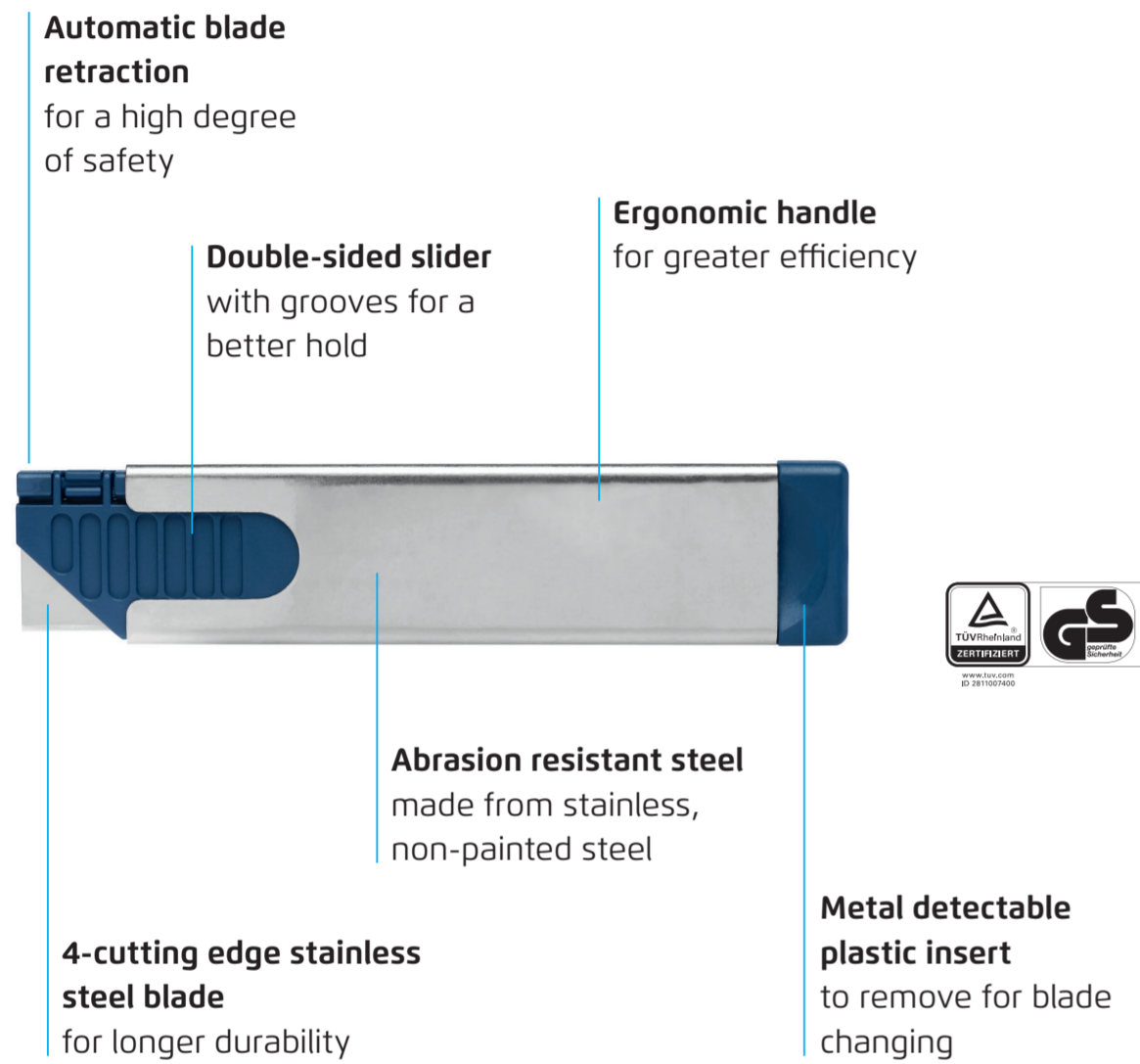
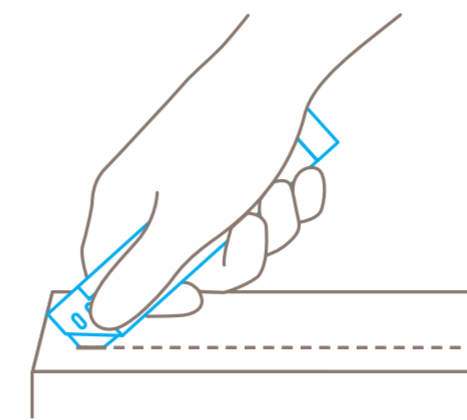

Pierce into the cutting material to cut.

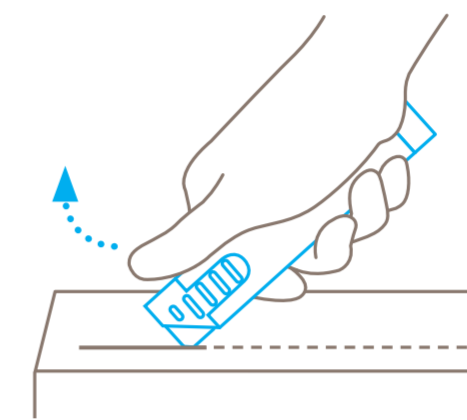

Always remove your **thumb from the slider** to ensure automatic blade retraction.

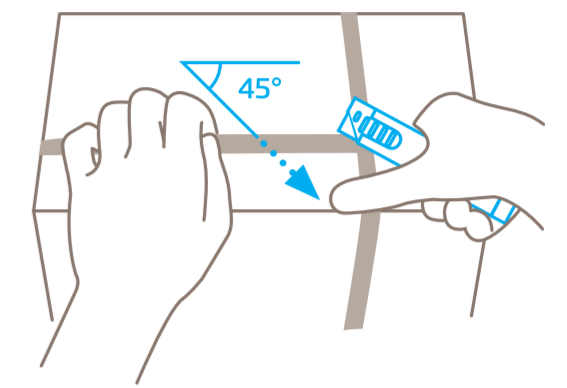

For best results, cut plastic strapping band **diagonally** (at a 45° angle).

BLADE CHANGE

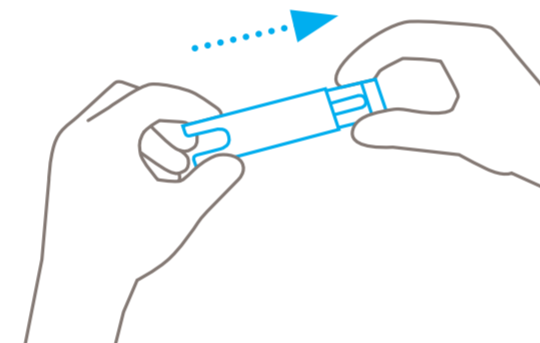

Pull plastic part out of handle's end. **Don't** pull the insert while holding onto the slider.

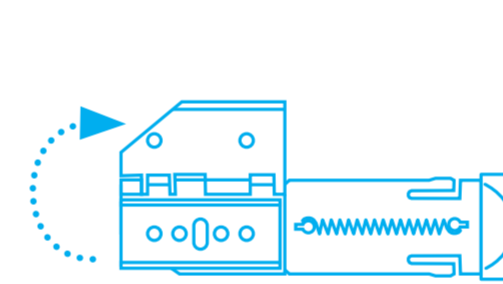

Open up the blade cover.

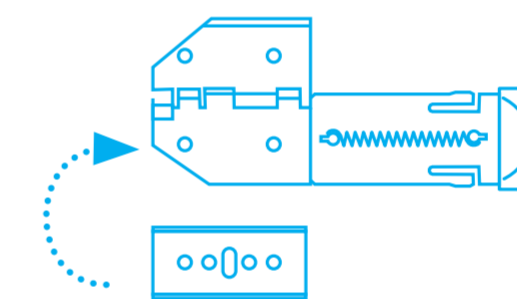

Reverse or replace the blade, make sure it fits **exactly** over the locating lugs.

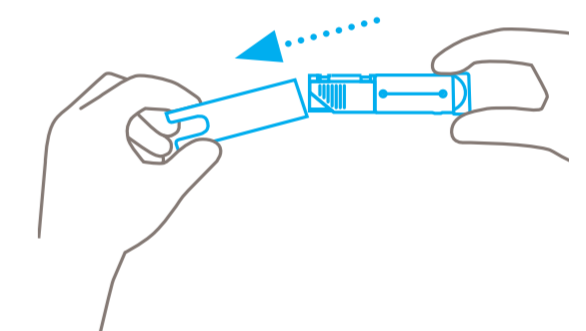

Finally, re-insert the plastic insert and blade **fully into the handle**.

Please note: To ensure your product always functions flawlessly, regularly remove any impurities. For additional safety, we recommend wearing gloves.

PROTECTION OF USER

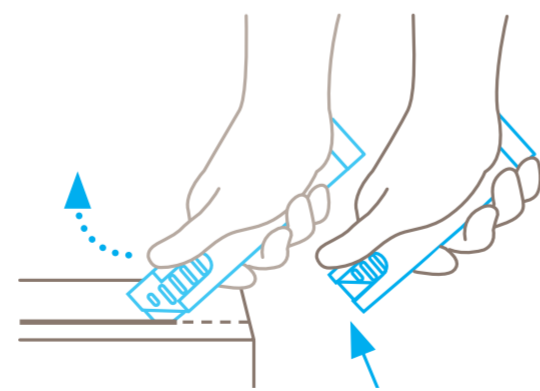

Following cutting, the blade immediately retracts into the handle. Condition: you have **released hold of the slider**.

PROTECTION OF GOODS

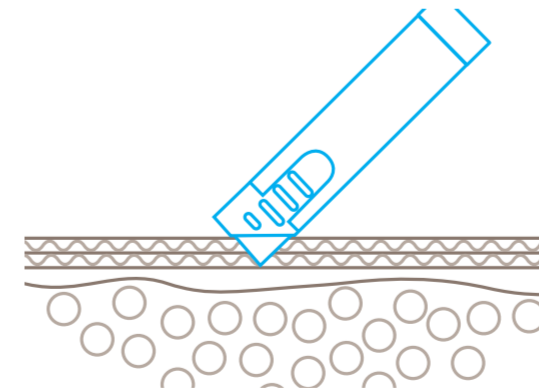

An appropriately **small cutting depth** serves to protect your goods.

DISPOSAL

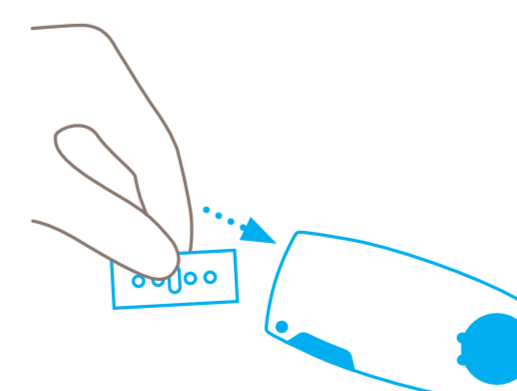

Your **SAFEBOX** is the best place to store **used blades**.

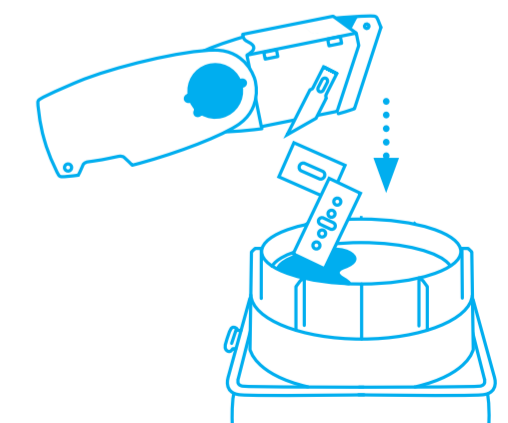

When the **SAFEBOX** is full, **empty all contents** into your **USED BLADE CONTAINER**.