

SECUMAX 150 MDP

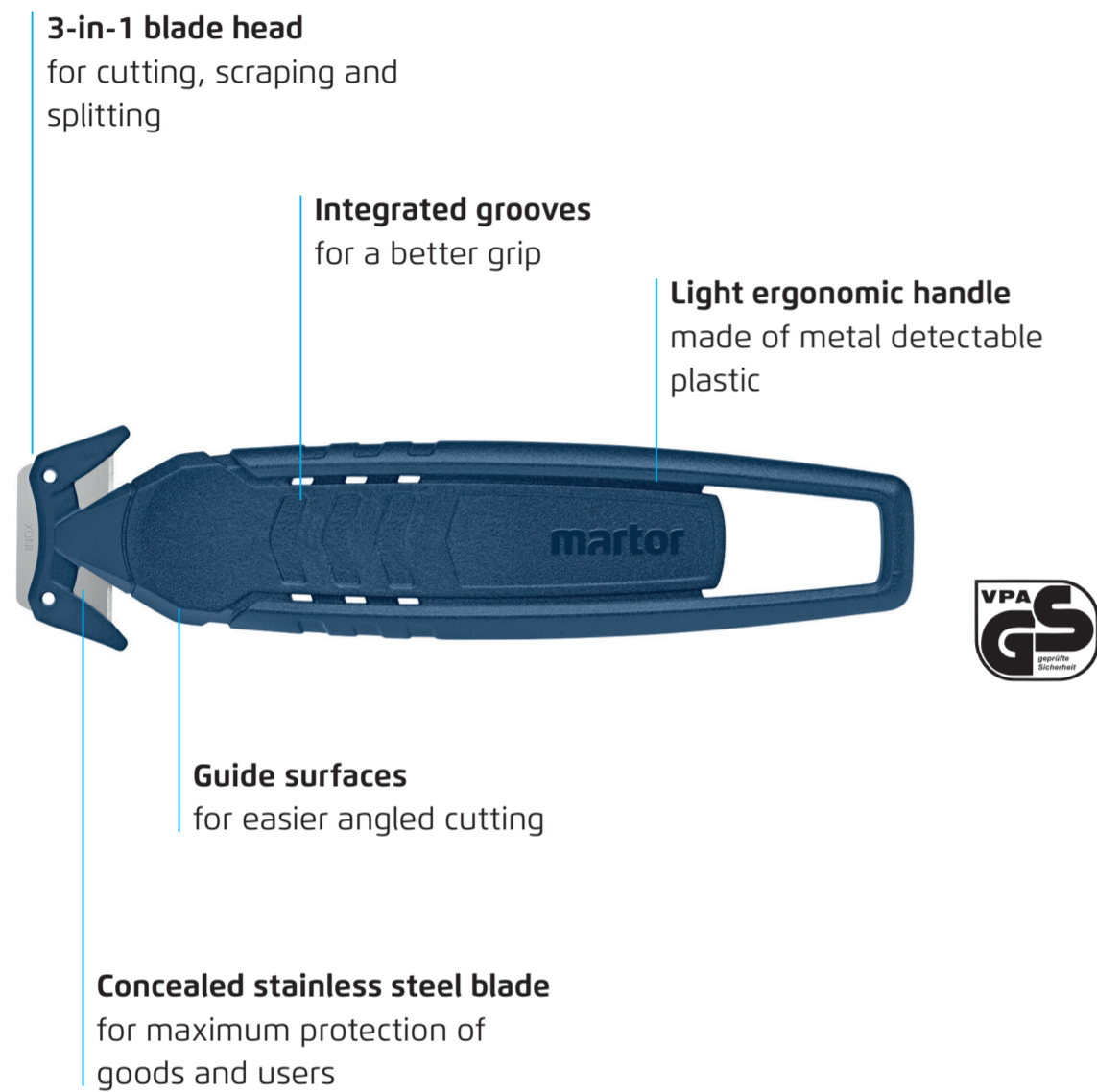

USAGE

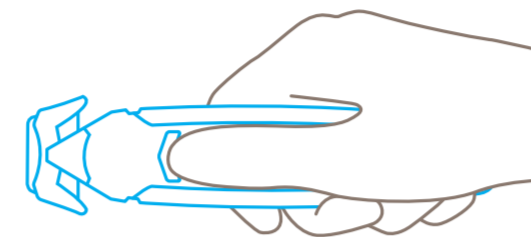

For the best possible grip, place your thumb on the **grooved surface**.

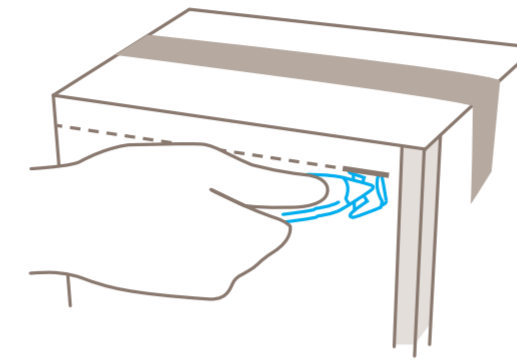

Pierce into the cutting material using either side of the cutter head.

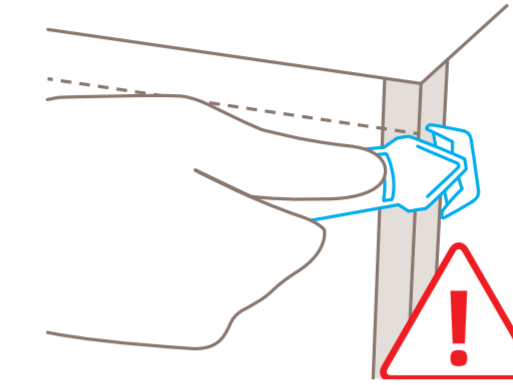

Do not lever against staples, nor force into edge protectors!

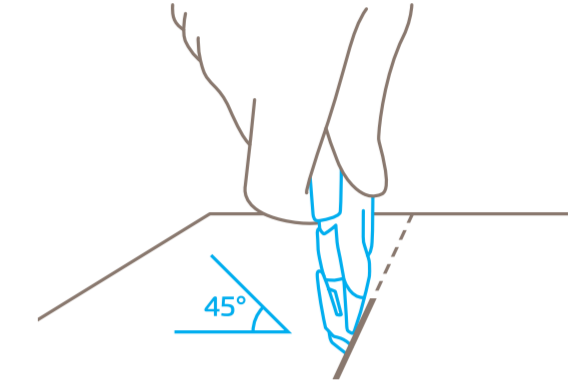

Hold the cutter at a **slight angle** when cutting open cardboard boxes.

USAGE

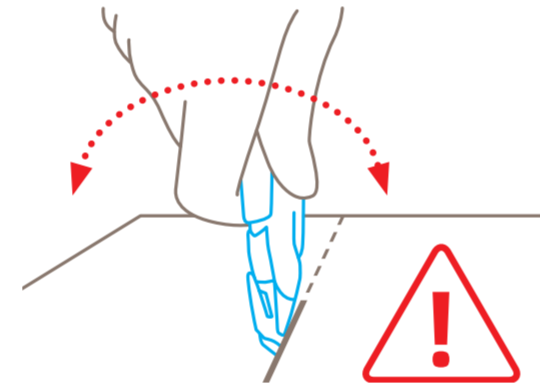

If the blade head becomes stuck, **don't forcefully lever** the cutter!

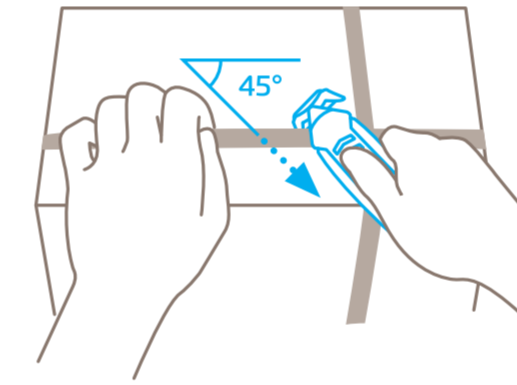

For best results, cut plastic strapping band **diagonally** (at a 45° angle).

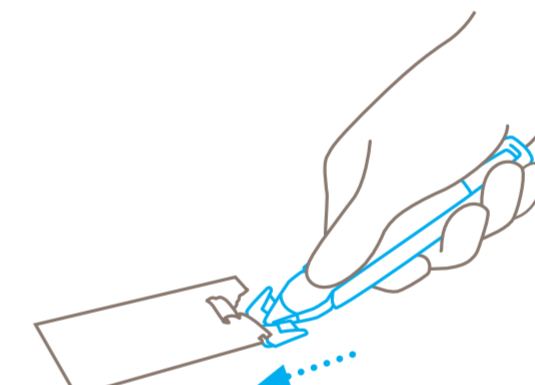

Use the small scraper at the head of the cutter for **light scraping work**: e.g. to remove labels.

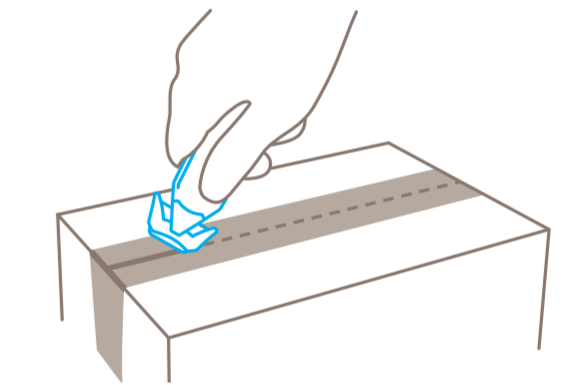

Open cardboard boxes that have been taped closed by using either side of the scraper as a **tape splitter**.

PROTECTION OF USER

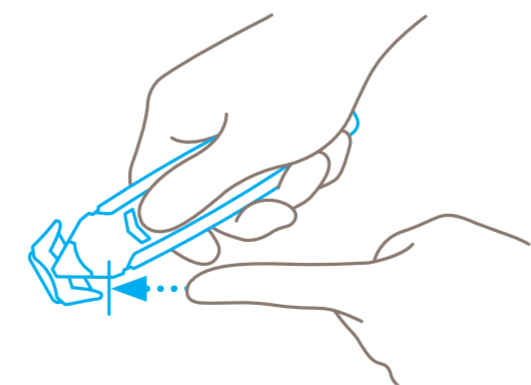

The concealed blade provides a maximum degree of **protection from cut injuries**.

PROTECTION OF GOODS

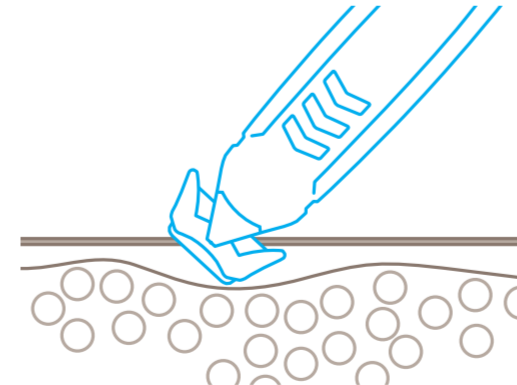

The concealed blade **will not get into contact with your goods** either.

DISPOSAL

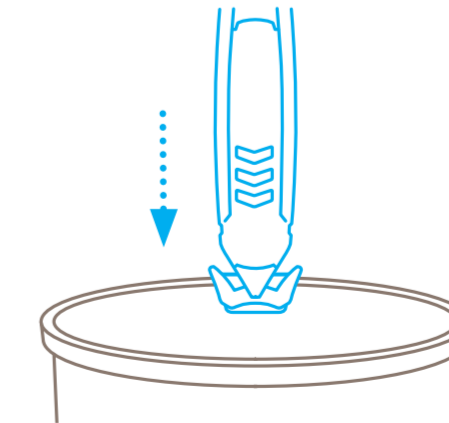

The SECUMAX 150 MDP is a throw-away cutter that can be safely disposed of **with your general waste**.

Please note: To ensure your product always functions flawlessly, regularly remove any impurities. For additional safety, we recommend wearing gloves.