

# SAFETY KNIFE SECUNORM 300

ORDER NOW!

Order No.	30000310.02
Knife size (L x W x H)	143 x 16 x 36 mm
Weight knife	51.5 g
Basic material	Recycled plastic, glass fibre reinforced
Variations	30000110, 30000210, 30000410



HIGH  
SAFETY



**Automatic blade retraction**  
for a high user protection

**Light ergonomic handle**  
for efficient working

**Blade change button**  
for particularly simple  
and safe blade change  
(incl. magnet)

**Cutting depth of just 5 mm**  
for extra protection of goods



**Double-sided slider**  
(incl. soft grip)  
for right and left handers

**Sustainable handle casing**  
made from at least 60 %  
recycled plastic plus fibreglass  
reinforcement

**2-cutting edge blade**  
for a double period of use

THE SAFER WAY TO CUT.

**martor**

# MARTOR SAFETY KNIFE SECUNORM 300



## SAFETY TECHNOLOGY



**SECUNORM**  
= high safety

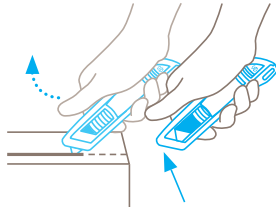

### Automatic blade retraction

The automatic blade retraction of the SECUNORM 300 guarantees a high degree of safety from cut injuries. As soon as you have started to cut, take your thumb off the slider. Then the blade will retract into the handle immediately after leaving the material being cut.

## TECHNICAL FEATURES



Safer blade change  
(with magnet)



Abrasion resistant



Very ergonomic



2-cutting edge blade



Cutting depth



Rounded-tip trapezoid  
blade



Ceramic blade compatible



Soft grip



For right and left handers



Lanyard hole



Printable for promotional  
purposes

## EXAMPLES OF USE



## MAIN CUTTING MATERIALS



Cardboard: up to 2-ply



Wrapping, stretch and  
shrink foil



Plastic strapping band



Tape



Bagged goods



Layers of foil or paper



Yarn, cord



Textile, material

## MOUNTABLE BLADES

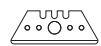

**TRAPEZOID BLADE NO. 65232** **NO. 65232.70**  
0.63 mm, rounded blade tips, deep-edged,  
10 in dispenser



**TRAPEZOID BLADE NO. 165232** **NO. 165232.70**  
0.63 mm, stainless, rounded blade tips,  
deep-edged, 10 in dispenser

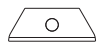

**CERAMIC BLADE NO. 65232C** **NO. 1765232.25**  
0.65 mm, ceramic, rounded blade tips,  
deep-edged, 2 on self-service card

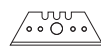

**TRAPEZOID BLADE NO. 5232** **NO. 5232.70**  
0.63 mm, deep-edged, 10 in dispenser



**TRAPEZOID BLADE NO. 5233** **NO. 5233.70**  
0.63 mm, 1-sided ground-edge, 10 in dispenser

Further mountable blades at [www.martor.com](http://www.martor.com).

## PACKING INFORMATION

**Packaging unit** 1 in single unit box  
(10 knives in multipack)

**Size Single unit box** 154 x 38 x 22.0 mm

**Weight single unit box** 64.0 g

**EAN Code single unit box** 4002632804526

**Size outer pack** 115 x 80 x 160.0 mm

**Weight outer pack** 685.0 g

**EAN Code outer pack** 4002632854521