

SAFETY KNIFE

SECUMAX 350 SE

ORDER NOW!

Order No.	350145.02
Knife size (L x W x H)	152 x 12 x 40 mm
Weight knife	37.0 g
Basic material	Recycled plastic
Variations	350040.02 350045.02



MAXIMUM SAFETY



6 mm cutting depth
for all common cutting materials

SECUMAX BLADE NO. 13448
Blade thickness: 0.50 mm,
stainless



Concealed blade
for maximum protection
of users and goods

Light ergonomic handle
for comfortable working

Blade change button
incl. access to spare blade
head



2-cutting edge blade
for a double period of use

Sustainable handle casing
made from at least 98 %
recycled plastic

Extra robust stainless steel blade head
for heavy-duty use (also in damp conditions)

THE SAFER WAY TO CUT.

martor

MARTOR SAFETY KNIFE SECUMAX 350 SE



SAFETY TECHNOLOGY



SECUMAX
= maximum safety

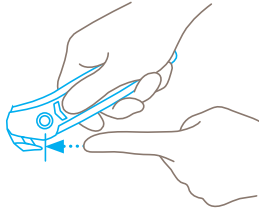

Concealed blade

The SECUMAX 350 SE blade is not an open one, but is hidden from people and goods. This provides you with a maximum degree of safety from cut injuries and from damage to goods.

TECHNICAL FEATURES



Tool-less blade change



Abrasion resistant



Very ergonomic



2-cutting edge blade



1 spare blade in knife body



Cutting depth



For right and left handers



Lanyard hole



Stainless



Printable for promotional purposes

EXAMPLES OF USE

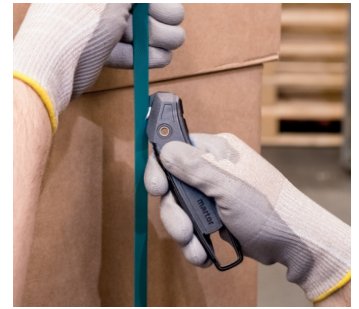

MAIN CUTTING MATERIALS



Cardboard: up to 2-ply



Wrapping, stretch and shrink foil



Tape



Plastic strapping band



Bagged goods



Layers of foil or paper



Yarn, cord



Felt

MOUNTABLE BLADES



SECUMAX BLADE NO. 13448
0.50 mm, stainless, 10 in box

NO. 13448.20



SECUMAX BLADE NO. 3448
0.50 mm, 10 in box

NO. 3448.20



SECUMAX BLADE NO. 3550
0.30 mm, 10 in box

NO. 3550.20

PACKING INFORMATION

Packaging unit 1 in single unit box
(10 knives in multipack)

Size Single unit box 160 x 15.5 x 42.0 mm

Weight single unit box 45.0 g

EAN Code single unit box 4002632804793

Size outer pack 88 x 80 x 162 mm

Weight outer pack 495.0 g

EAN Code outer pack 4002632854798