

SET SECUNORM 610 XDR WITH HOLSTER

ORDER NOW!

Order No.	610102.09
Size SET (L x W x H)	163 x 101 x 48 mm
Weight SET	221.0 g
Basic material	Aluminium + metal detectable plastic
Variations	610101.09



HIGH
SAFETY

18 mm cutting depth
for single-ply bags
and other cutting
materials

Safety knife
with maximum dirt resistance

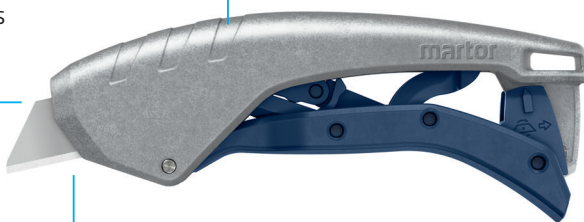

Automatic blade retraction
for a high user protection



HOLSTER 610 XDR
for custom-fit safe-keeping



Safety lock
for locking the
SECUNORM 610 XDR

THE SAFER WAY TO CUT.

martor

MARTOR SAFETY KNIFE SECUNORM 610 XDR WITH HOLSTER

SAFETY TECHNOLOGY



SECUNORM
= high safety

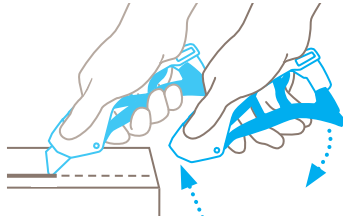

Automatic blade retraction

The SECUNORM 610 XDR is equipped with automatic blade retraction: as soon as you release the lever, the blade disappears into the handle – and it stays there too. This provides a high degree of safety from cut injuries.

EXAMPLES OF USE



CLEANING

WITH HOLSTER 610 XDR



Adjustable angle for ergonomic and efficient working, ideal for right and left-handed users.



Unlocked for quick removal of the safety knife. Locked for a secure hold.



Equipped with eyelets on both sides of the holster to ensure the knife is securely held in place and therefore prevent the knife being lost.

ATTACHMENT OPTIONS



To a belt or trouser pocket using the clip on the back of the holster.



At the workplace using a bracket (not included in the scope of delivery, order NO. 9962.06).



Also use the integrated clip to attach to the bracket.

PACKING INFORMATION

Packaging unit	1 set in cardboard-box
Size cardboard-box	165 x 87 x 50.0 mm
Weight cardboard-box	262,0 g
EAN Code cardboard-box	4002632804670

For further information please contact us: **MARTOR UK LIMITED** | Unit 2, Monaco Works, Station Road | Kings Langley, Herts, WD4 8LQ | United Kingdom | T +44 1924 281333 | sales@martor.co.uk | www.martor.co.uk