

SAFETY POSTER INSTRUCTIONS FOR THE SAFE HANDLING OF YOUR CUTTING TOOL

martor

SECUPRO MERAK

Fully automatic blade retraction
for a very high degree of safety

Ergonomic handle
for greater efficiency

Blade change button
to release the lever and the blade therein

Safety lock
to lock and unlock the lever

Smooth, easy-to-squeeze lever
to release the blade

4-times usable blade
for a particularly long period of use



USAGE

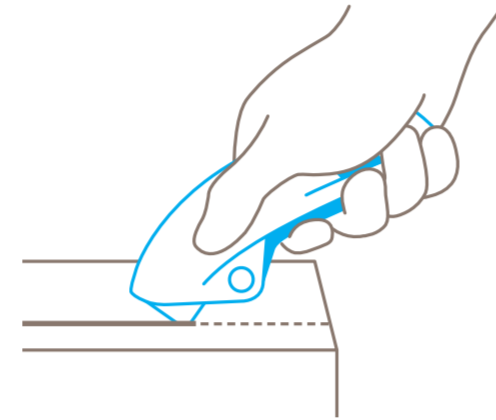

To engage the blade, unlock the cutter and **squeeze the lever**. Now you can cut.

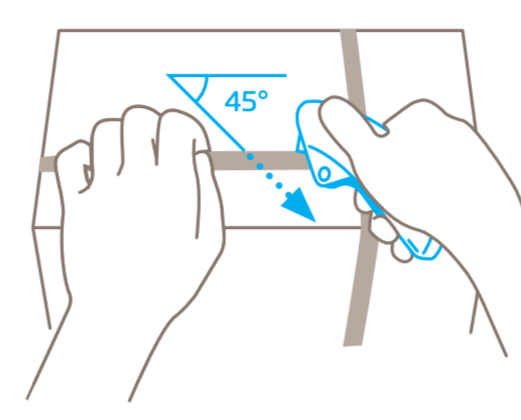

For best results, cut plastic strapping band **diagonally** (at a 45° angle).

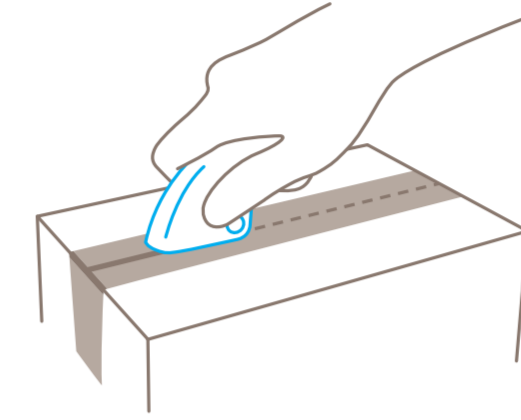

Use the underside of the cutter head as a supporting surface to **work ergonomically** and efficiently.

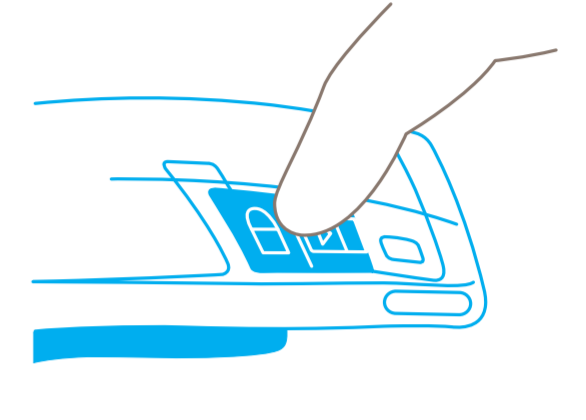

To prevent unintentional blade activation, always **lock the cutter** by pressing downwards on the lock symbol.

BLADE CHANGE

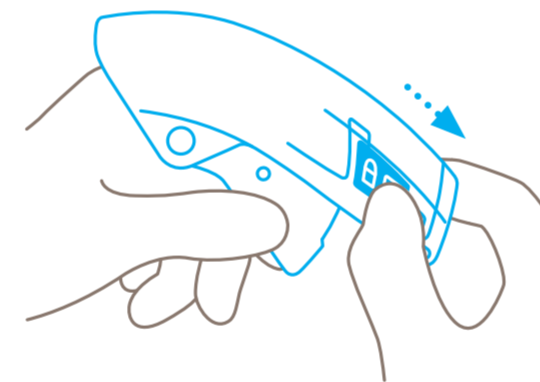

Lock your cutting tool and pull back on the small **black blade-change button**.

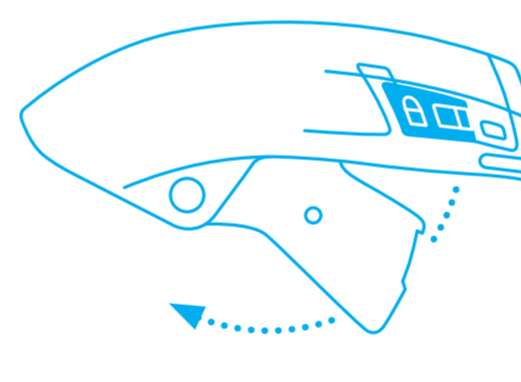

Swing the lever out of the handle and flip open the blade cover.

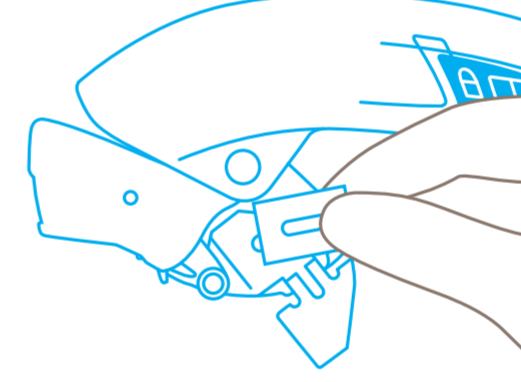

Now you can either **rotate or replace** the blade. Flip the blade cover closed.

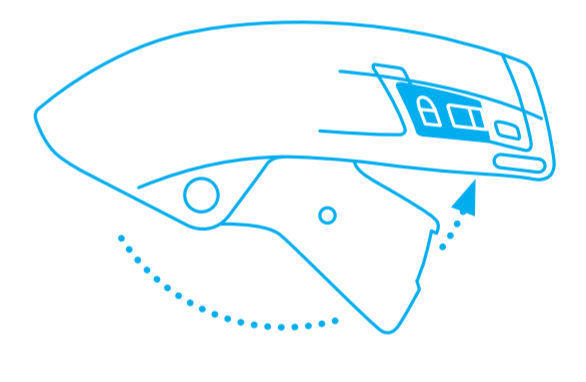

Finally, push the lever back into the handle until you **hear it click into place**.

PROTECTION OF USER

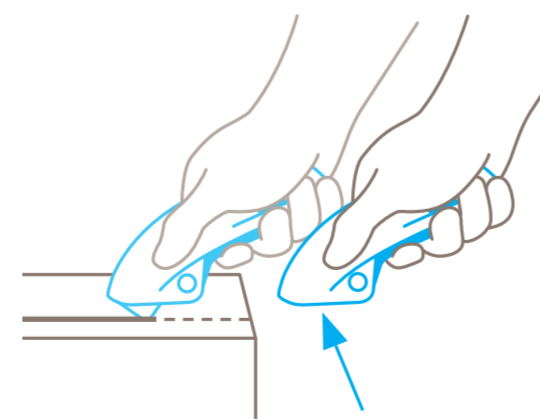

The blade automatically retracts into the handle the moment cutting ceases. Even when the lever is **still being squeezed**.

PROTECTION OF GOODS

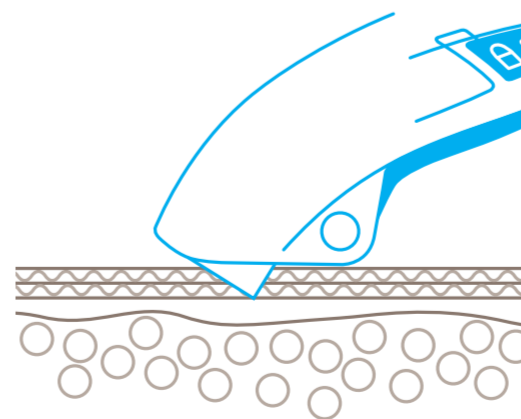

An appropriately **small cutting depth** serves to protect your goods.

DISPOSAL

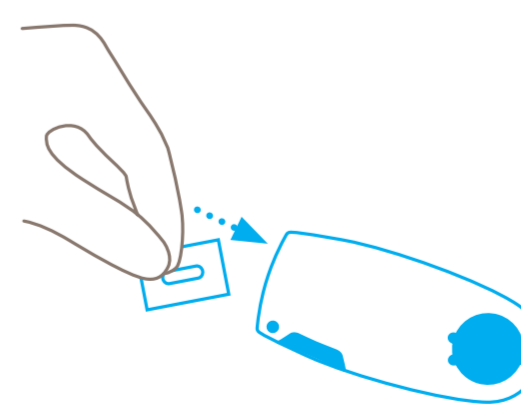

Your **SAFEBOX** is the best place to store **used blades**.

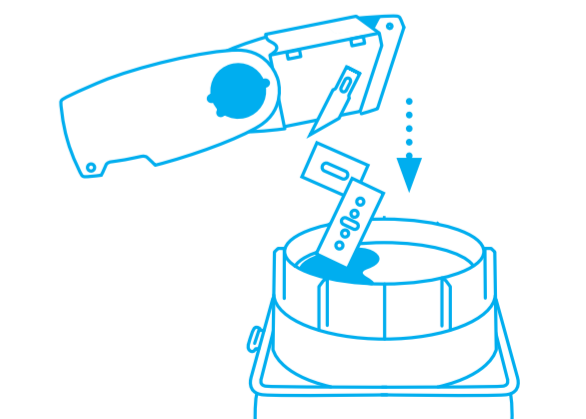

When the **SAFEBOX** is full, **empty all contents** into your **USED BLADE CONTAINER**.

Please note: To ensure your product always functions flawlessly, regularly remove any impurities. For additional safety, we recommend wearing gloves.